

TECHNICAL DATASHEET

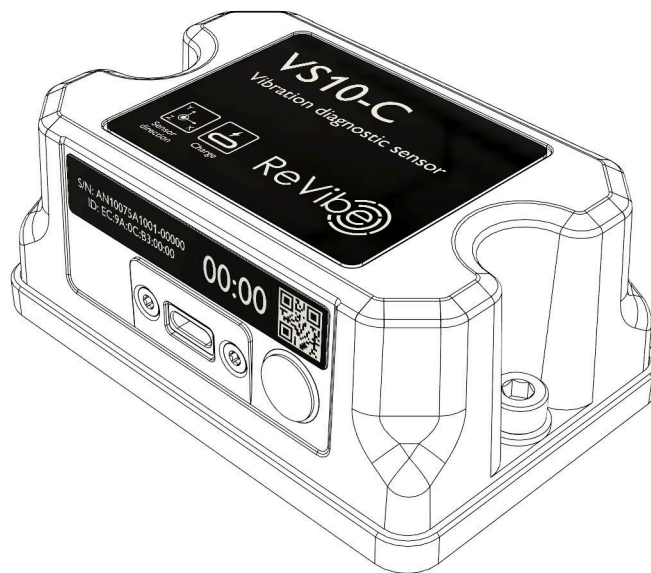

VS10-C

10075 ANURA Vibration sensor powered by rechargeable battery



SPECIFICATION	3
Power supply:.....	3
Power consumption:.....	3
Enclosure material:.....	3
Ingress protection:.....	3
Typical weight (w. 2x 32mm pot magnets) :.....	3
Dimensions (excluding mounting accessories):.....	3
Dimensions: (w. 2x 32mm pot magnets.).....	3
Operating Temperature:.....	3
Storage Temperature:.....	4
Relative humidity:.....	4
Mounting interface:.....	4
Radio communication:.....	4
Acceleration measurements:.....	4
Temperature sensor measurement accuracy:.....	5
Edge data storage:.....	5
Time synchronization offset:.....	5
Expected product lifetime:.....	5
Bounding box.....	5
Accelerometer position.....	6
CONTACT	7
Manufacturer:.....	7

SPECIFICATION

Power supply:

Lithium Ion Rechargeable battery 1.32 Wh.
Charged via USB-C, 5V.

Power consumption:

Mode/configuration	Power consumption
Sampling rate: 1024 Hz, duration: 3 seconds, transmission interval: 5 minutes	~8 mW
Sampling rate: 8192 Hz, duration: 5 seconds, transmission interval: 5 minutes	~10 mW
Standby mode	<1 mW
Shutdown	~20 μ W

Enclosure material:

Bottom plate: Anodized aluminum alloy, color "Orange".
Casing: PA6, Black.

Ingress protection:

IP65

Typical weight (w. 2x 32mm pot magnets) :

290g.

Dimensions (excluding mounting accessories):

90x60x38 mm (height x width x depth)

Dimensions: (w. 2x 32mm pot magnets.)

90x60x46 (height x width x depth)

Operating Temperature:

-40°C to +80°C

Storage Temperature:

0°C to +45°C (-40°F to +140°F)

Relative humidity:

0 to 95%, non-condensing.

Mounting interface:

- 2x M5 threaded holes, (c/c) 50mm for pot magnets.
- 2x M6 threaded holes, (c/c) 76.5mm. Use M5 for through hole mounting.

Radio communication:

Tx Power:
0 dBm

Rx Sensitivity:
-98 dBm

Data Rates:
Up to 1 Mbps

Frequency:
2.400 to 2.483 GHz

Antenna Gain:
typ. 6dBi

Acceleration measurements:

3 Axis MEMS accelerometer.

Range
±16g

Sampling rate
Selectable: 256, 512, 1024, 2048, 4096, 8192, 16384.

Sensor data filtering
3dB point at $\frac{1}{3}$ of the selected sampling rate.

Accelerometer frequency response
XY-plane: dc to 4kHz (± 3 dB point)
Z-axis dc to 1.6kHz (± 3 dB point)

Temperature sensor measurement accuracy:

Typ. $\pm 0.5\text{ }^{\circ}\text{C}$ -40°C to 125°C
Typ. $\pm 0.25^{\circ}\text{C}$, 0°C to $+65^{\circ}\text{C}$

Edge data storage:

Non persistent 64Mbit RAM.

Time synchronization offset:

Typ. $<5\ \mu\text{s}$

Expected product lifetime:

>2 years

Bounding box

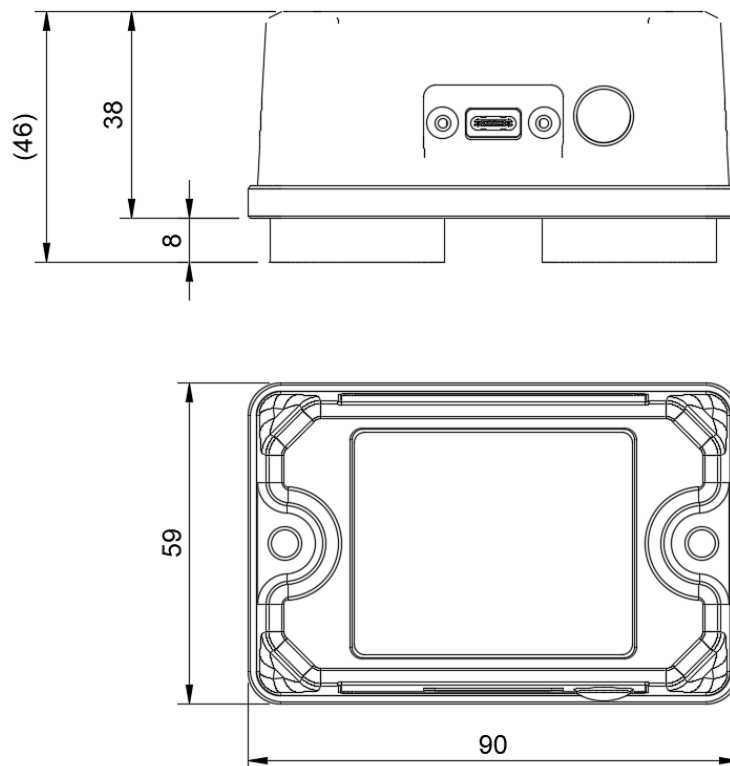

Accelerometer position

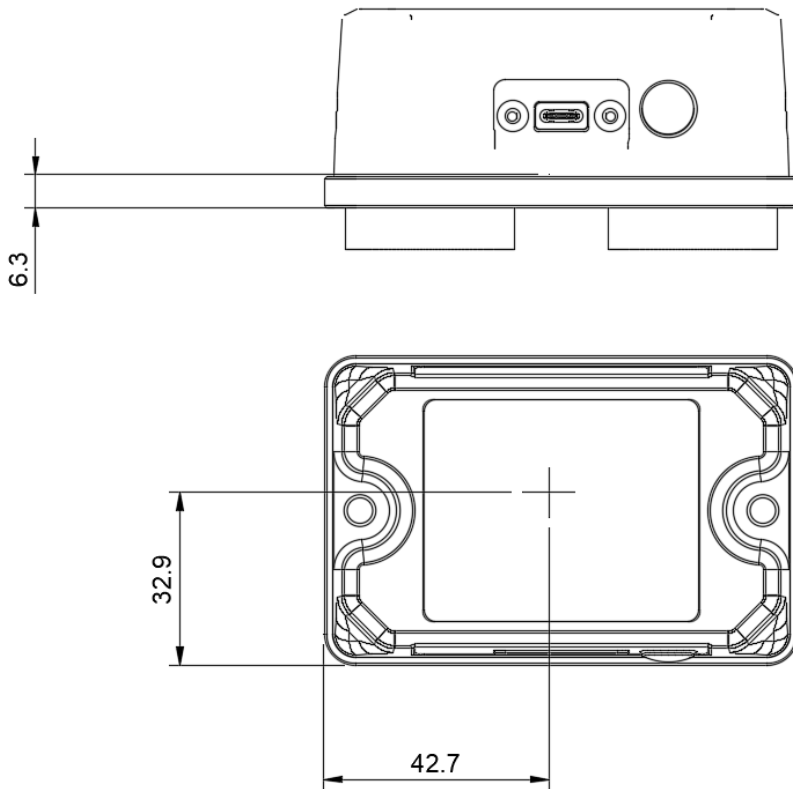

CONTACT

Manufacturer:

Revibe Energy AB
Mölnadalsvägen 95
412 63 Göteborg
Sweden
+46 (0) 31 24 23 22
www.revibeenergy.com

